

MINIMELF

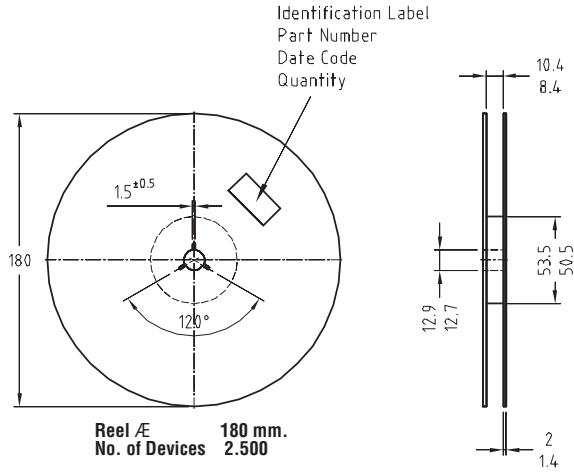

TAPE & REEL

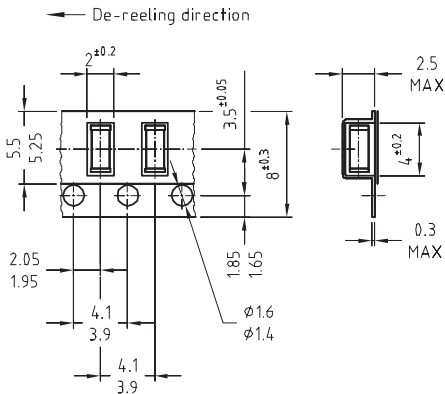

Notes:

1. Maximum of 0.5% of the total number of components per reel may be missing-exclusively at the beginning and at the end of the reel.
2. A maximum of three consecutive components may be missing provided this gap is followed by six consecutive components.

Drawing are not to scale

Packaging Specifications

Dimensions in mm.

MINIMELF

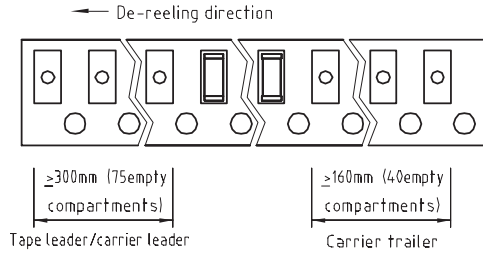

Drawing are not to scale

Packing Detail

| PACKAGE     | STANDAR D PACK |                  | INNER CARTON BOX       |     | OUTER CARTON BOX                           |             |                     |
|-------------|----------------|------------------|------------------------|-----|--|-------------|---------------------|
|             | Details        | Net Weight /Qty  | Size                   | Qty | Size                                       | Qty         | Gr Wt               |
| SOD-80C T&R | 2.5K /reel     | 225 gm /2.5K pcs | 228.6 x 228.6 x 2.28.6 | 40K | 457.2 x 304.8 x 254<br>482.6 x 482.6 x 508 | 80K<br>320K | 7.2 kgs<br>28.8 kgs |